

CW SINGLE COMPRESSION



BS 6121 INDUSTRIAL TYPE GLANDS



ARMoured CABLE GLANDS CW SERIES

TECHNICAL DETAILS

Type : CW (Single compression gland)
 Certificates : ROHS, CE, PT, TUV
 Material : Brass with or without nickel plated
 Standards : BS 6121
 Protection class : IP66 & IP67
 Temperature : -20 °C +80 °C:
 Thread options : Metric , NPT , BSP & PG
 Application : For indoor or outdoor use with all types of SWA cables
 Accessories : Matches accessories available like PVC Shrouds locknuts & earth tag

Function : CW type glands provide a seal on the outer sheath and an armour specific armour clamp for an armoured cable. the armour clamp provides an electrical bond armour cable and the gland.

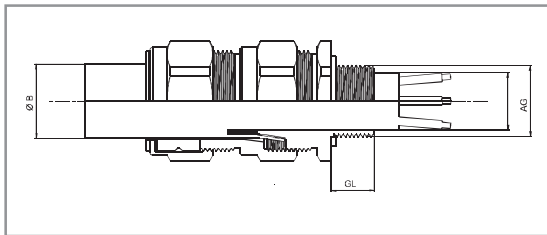

PRODUCT RANGE OVERVIEW

Product Size	Product Code	Standard AG	AG NPT	B		GL mm
				Min	Max	
20s	CW-M20s	M20 x 1,5	1/2"	11,5	15,5	10
20L	CW-M20L	M20 x 1,5	1/2"	14	20,5	10
25s	CW-M25s	M25 x 1,5	3/4"	18	24	10
25L	CW-M25L	M25 x 1,5	3/4"	20	27,2	10
32L	CW-M32L	M32 x 1,5	1"	26,3	33,5	10
40s	CW-M40s	M40 x 1,5	1 1/4"	31,5	39,5	13
40L	CW-M40L	M40 x 1,5	1 1/4"	32	40	13
50s	CW-M50s	M50 x 1,5	1 1/2"	38,2	46,3	13
50L	CW-M50L	M50 x 1,5	2"	44	52,6	13
63s	CW-M63s	M63 x 1,5	2"	50,1	59	14
63L	CW-M63L	M63 x 1,5	2 1/2"	56	65,3	14
75s	CW-M75s	M75 x 1,5	2 1/2"	62	71,6	15
75L	CW-M75L	M75 x 1,5	3"	68	78	15
90L	CW-M90L	M90 x 2	3"	80,5	91	20